

UV PRINTING FILE SETUP GUIDE

The UV printer uses a CMYK, White, and Clear substrate that hardens on most surfaces with the application of UV light. White ink can be used to make surfaces opaque whereas clear ink applies a gloss to the surface.

MATERIAL SELECTION

The print bed size is 20 inches by 13 inches, all objects must fit within the bed size to be printed. The maximum height of an object that can fit the bed is 3.97 inches.

For best quality prints :

Completely flat surface

A solid material like Paper, Metal, Wood, or plastic

Smooth, untextured surfaces

Heavy, sturdy

Materials that are bent, lightweight and or move easily will need to be taped down to the bed. Not allowing for full bleed (to the edge) prints.

Approved Material

Wood / Plywood / PVC / Vinyl / Plexi / Film / Metal Sheet / Copper Plate / Plastic / Paper / Cardboard / Chipboard / Paper Packages / Notebooks / Ceramics

Unorthodox Approved Materials:

A block of Candy / Plastic Garbage bags / Condom Packets / Menstruation Pads / Organic Degradable Plastic / Flattened blob(?) / iPhone Cases / Records / Bones / Bread

Banned Materials

Nets / Fabrics / Garments / Plastic Balloons / Mirrors
Knitted Anything / Natural Sponge / Hot foods / Fruits /

HOW IT WORKS

UV SUBSTRATE
SPRAYED
ONTO
SURFACE TO
MAKE IMAGE

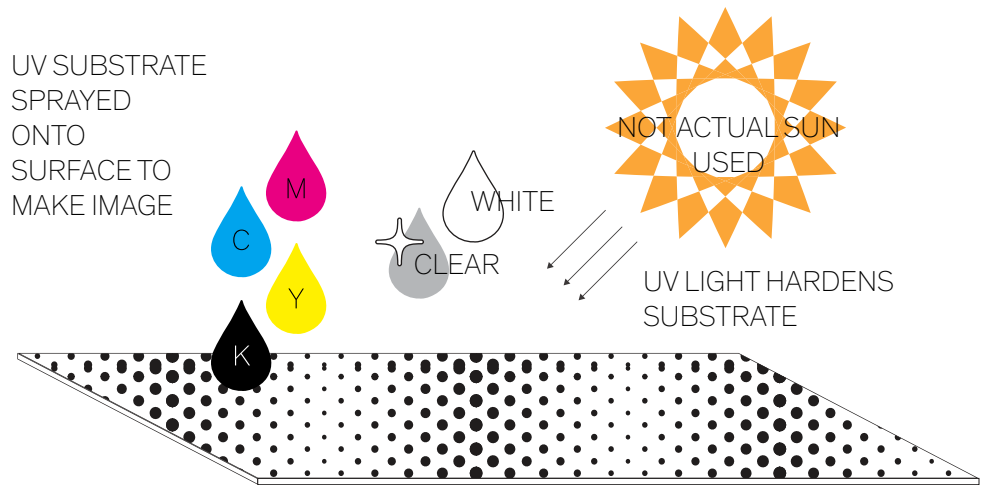

SIZE & MATERIAL

IDEALLY.....

- FLAT
- HARD
- SMOOTH
- HEAVY

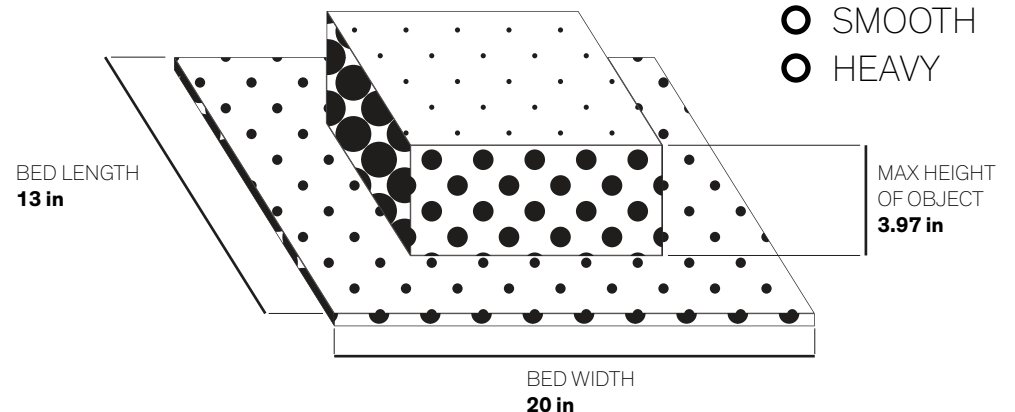

FILE SETUP

1. Set up your file on **Adobe Illustrator**
2. Make your artboard the Size of the material you are printing on - **MAX 20in by 13in**
3. Make sure your file is in **LANDSCAPE**
4. Create three layers :
GLOSS
DESIGN
WHITE
- In the order presented
5. For the gloss and white layer, you can only have **vector shapes**
- The shapes for gloss or white are where the printer will print using gloss or white
6. Make sure all your **text are outlined**
- You can outline your text by selecting all your text and going to Type > Create Outline (or Command + Shift + O)
6. Specific saving instruction on next page

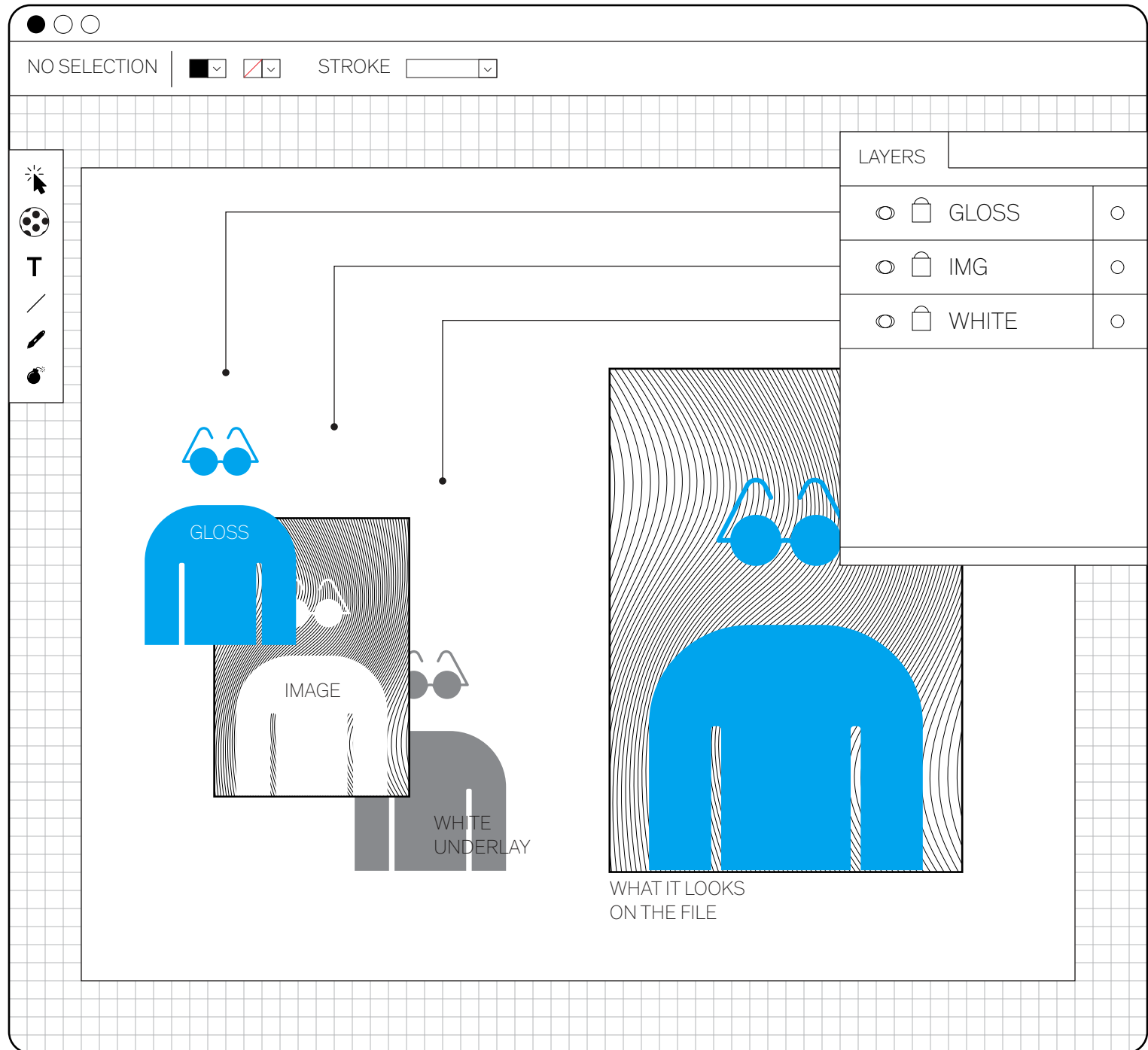

SAVING & SUBMITTING

Label your file :

Lastname _ Material you are printing on _ date created (MM.DD.YY)
i.e : Blake _ Scroll _ 08.27.1795

When Illustrator options appear make sure to :

- **Choose version Illustrator CC (Legacy)**
- **Check Include Linked Files**

Everything else should be left as their Default.

Once your file is setup

Submit file through Submission form below



CLICK ME

After Submission...

Wait for your file to be approved

If your file is incorrect you will be asked to correct it

Payment will be determined by the size of your artboard

and the number of prints - a print is considered a print on one side of the material regardless of ink type

A link with the amount to purchase will be sent to you once your file is approved, then go ahead and drop off your material at the Design Lab

Once payment is confirmed your job will be placed on the queue
An approximate completion date will be sent to you

It may take from 3-21 business days to print

ILLUSTRATOR OPTIONS

VERSIONS:

ILLUSTRATOR CC LEGACY

FONTS

THEY ARE OUTLINED? NO? WHY NOT?

OPTIONS

- CREATE PDF COMPATIBLE FILE**
 - INCLUDE LINKED FILES**
 - EMBED ICC PROFILES
 - USE COMPRESSIONS**
 - SAVE EACH ARTBOARD TO A SEPERATE FILE
- NO

TRANSPARENCY... ETC

CANCEL

OK

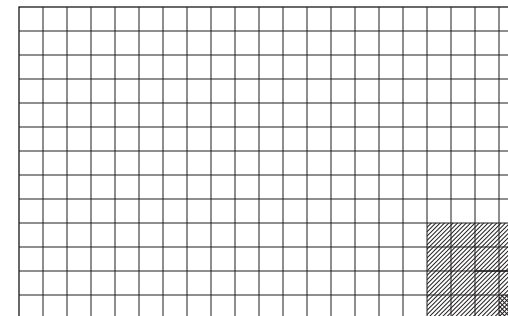

20" x 13"

Every square inch of your print is \$0.01

i.e
 $20" \times 13" = 260"$
 $260 \times \$0.01 = \2.60

\$0.16

\$0.01